

Codice / Code	L (mm)	Descrizione Description	Kg/ml
80.08.60.450G	4500	Grezzo Raw	1,033
80.08.60.450	4500	Anodizzato Anodized	1,033
80.08.60.600G	6000	Grezzo Raw	1,033
80.08.60.600	6000	Anodizzato Anodized	1,033
80.08.60.670G	6700	Grezzo Raw	1,033
80.08.60.670	6700	Anodizzato Anodized	1,033
80.08.60.760G	7600	Grezzo Raw	1,033
80.08.60.760	7600	Anodizzato Anodized	1,033

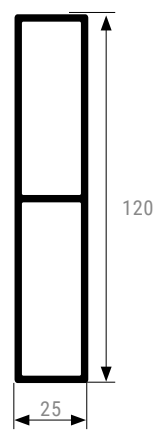

Codice / Code	L (mm)	Descrizione Description	Kg/ml
80.08.61.620G	6200	Grezzo Raw	1,64
80.08.61.620	6200	Anodizzato Anodized	1,64
80.08.61.760G	7600	Grezzo Raw	1,64
80.08.61.760	7600	Anodizzato Anodized	1,64



Codice / Code	L (mm)	Descrizione Description	Kg/ml
80.08.62.620G	6200	Grezzo Raw	1,7
80.08.62.620	6200	Anodizzato Anodized	1,7
80.08.62.670G	6700	Grezzo Raw	1,7
80.08.62.670	6700	Anodizzato Anodized	1,7
80.08.62.760G	7600	Grezzo Raw	1,7
80.08.62.760	7600	Anodizzato Anodized	1,7



Codice / Code	L (mm)	Descrizione Description	Kg/ml
80.08.64.670G	6700	Grezzo Raw	1,031

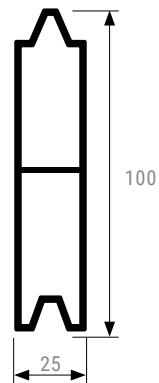

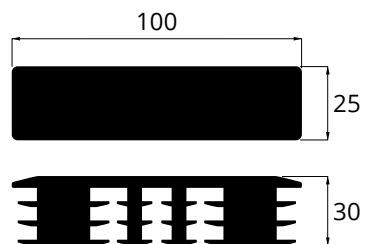

66 6213001

L (mm)	W (mm)	H (mm)	Kg	Pezzi / Pack
100	25	30	0,021	1

Terminale in PVC per sovrasponde
PVC cap for side planks 100x25

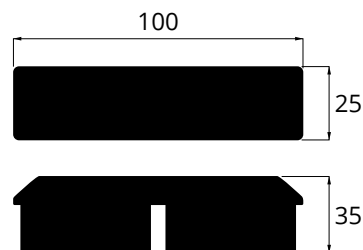

70 001101

L (mm)	W (mm)	H (mm)	Kg	Pezzi / Pack
100	25	35	0,011	1

Terminale in gomma per sovrasponde - per bicamera
Rubber cap for side planks 100x25

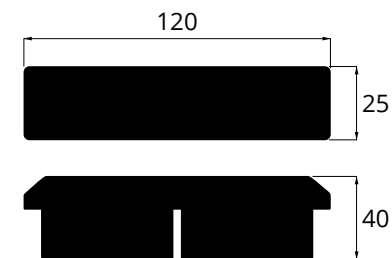

70 001102

L (mm)	W (mm)	H (mm)	Kg	Pezzi / Pack
120	25	40	0,070	1

Terminale in gomma per sovrasponde
Rubber cap for side planks 120x25



Foto 70 017105

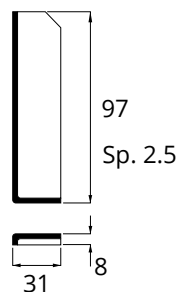

70 017105 (DX)

70 017106 (SX)

L (mm)	W (mm)	H (mm)	Kg	Pezzi / Pack
31	8	97	0,080	1

Tasca grezza in ferro
destra (70 017105) o sinistra (70 017106)
da completare con 70 017104
Raw steel bracket
right (70 017105) or left (70 017106) to be
completed with 70 017104

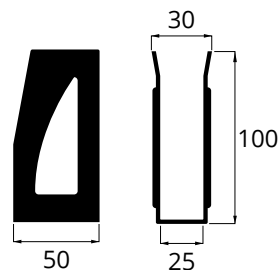
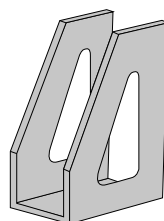

70 017100 (GREZZA/RAW)

70 017110 (INOX)

L (mm)	W (mm)	H (mm)	Kg	Pezzi / Pack
30	50	100	0,135	1

Innesto centina per sponda da 25 - grezza (70 017100)
o inox (70 017110)
Bracket for 25 board - raw (70 017100) or inox (70 017110)

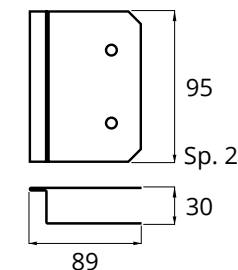
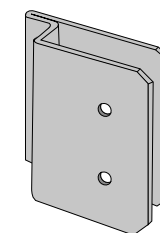

70 017104

L (mm)	W (mm)	H (mm)	Kg	Pezzi / Pack
89	30	95	0,300	1

Innesto centina zincato - destro o sinistro
Galvanized bracket - right or left