

11 ANCORAGGI LOAD RESTRAINT

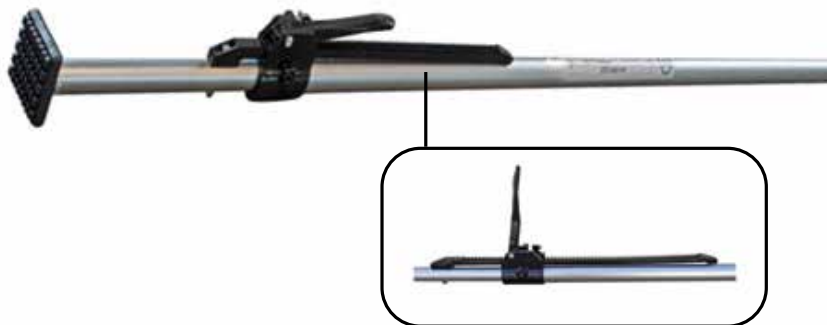

V17 - 2025

01. BARRE FERMACARICO • SHORING POLES
02. PROFILI ANCORAGGIO • LASHING PROFILES
03. GANCI ANCORAGGIO PER BANDELLE • LASHING POINTS
04. SISTEMI TRASPORTO SPECIALI • LOAD RESTRAINT SYSTEMS
05. CAVALLOTTI PER ANELLI ANCORAGGIO • LASHING HOOKS
06. GANASCE DI FISSAGGIO • CLAMPS
07. CINGHIE FERMACARICO • LASHING STRAPS



70 055188

Dimensioni / Dimensions	Kg	Pezzi / Pack
L = da 2350 mm a 2745 mm	4,5	1

Barra di ancoraggio in alluminio grezzo
Raw aluminum anchor bar

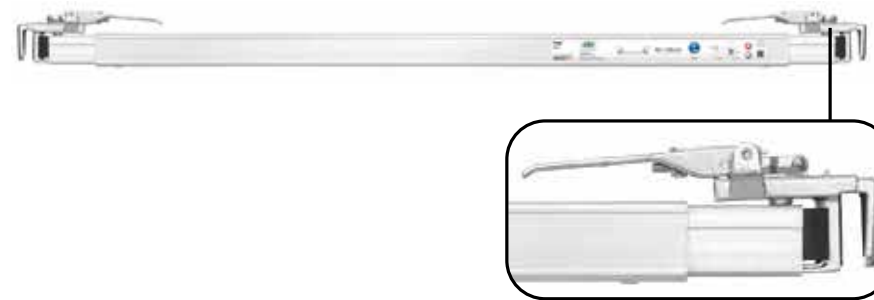

70 055190

Dimensioni / Dimensions	Kg	Pezzi / Pack
L = da 2400 mm a 2520 mm	14,5	1

Barra estensibile in alluminio - portata 1000 daN
Extendable aluminum bar - capacity 1000 daN



70 055201*

Dimensioni / Dimensions	Kg	Pezzi / Pack
L = da 2360 mm a 2760 mm	4,5	1

Barra fermacarico alluminio c/perno $\varnothing 19/24$ mm
Aluminium, adjustable, tube $\varnothing 42$ mm, with combi plugs $\varnothing 19/24$ mm

*Su richiesta
*On demand



70 055200

Dimensioni / Dimensions	Kg	Pezzi / Pack
L = da 2000 mm a 2500 mm	3,16	1

Barra fermacarico KIM 44 (innesto $\varnothing 19$ mm)
Load retaining bar KIM 44 ($\varnothing 19$ mm coupling)

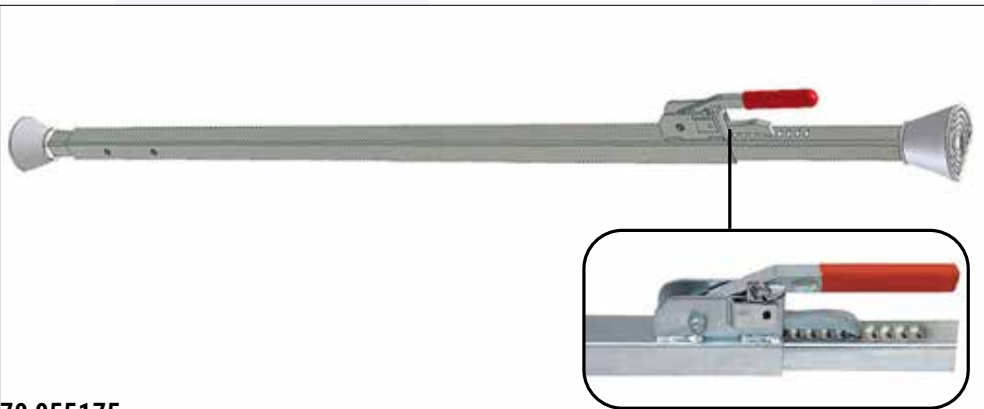

70 055175

Dimensioni / Dimensions	Kg	Pezzi / Pack
L = da 1935 mm a 2890 mm	6,7	1
Barra quadrata zincata Galvanized square block load bar		

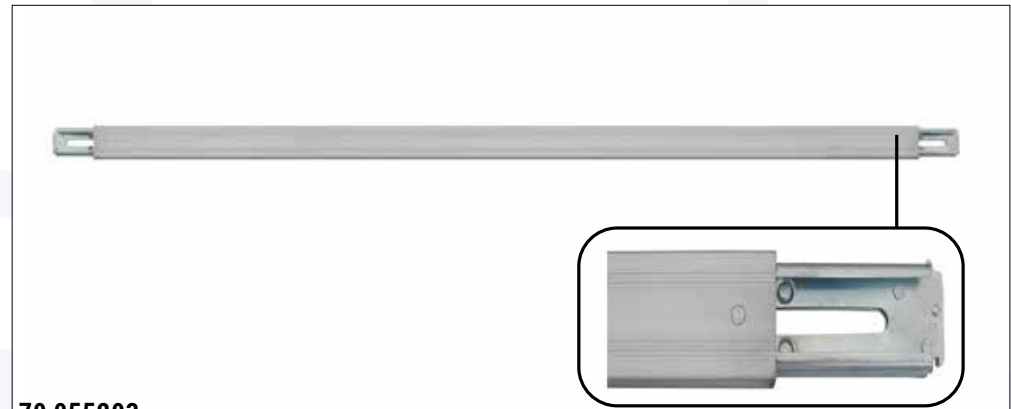

70 055203

Dimensioni / Dimensions	Kg	Pezzi / Pack
L = da 2310 mm a 2590 mm	10	1
Barra quadrata in alluminio per bandelle. Portata 1650 daN Aluminium square block load bar, 1650 daN		



66 0515022

Dimensioni / Dimensions	Kg	Pezzi / Pack
L = da 2360 mm a 2760 mm	8,2	1
Barra fermacarico tonda. Perno Ø 24mm Round block load bar. Pivot Ø 24mm		



70 055160

Dimensioni / Dimensions	Kg	Pezzi / Pack
L = da 2000 mm a 2400 mm	8,2	1
Barra fermacarico tonda. Perno Ø 19mm Round block load bar. Pivot Ø 19mm		

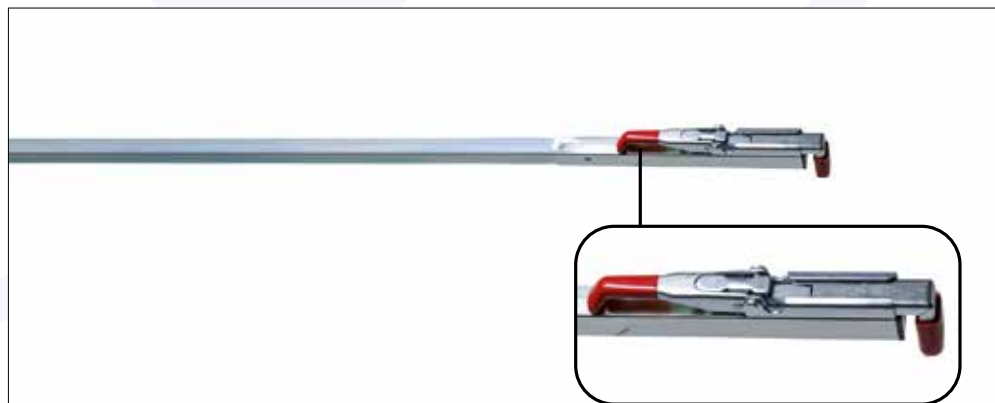

66 0515020

Dimensioni / Dimensions	Kg	Pezzi / Pack
L = da 1880 mm a 2880 mm	7	1

Asta fermacarico zincata regolabile
Adjustable galvanized load stop rod

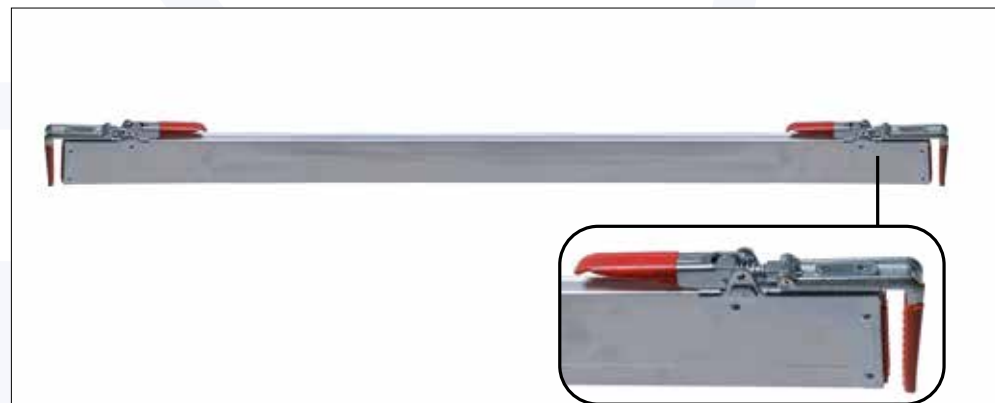

70 055123

Dimensioni / Dimensions	Kg	Pezzi / Pack
L = da 2400 mm a 2700 mm	9,56	1

Barra estensibile in alluminio, completa di 2 chiusure in acciaio (cod. 70 055-122)
Extendible aluminium bar, finished with two steel locks cod. 70 055-122

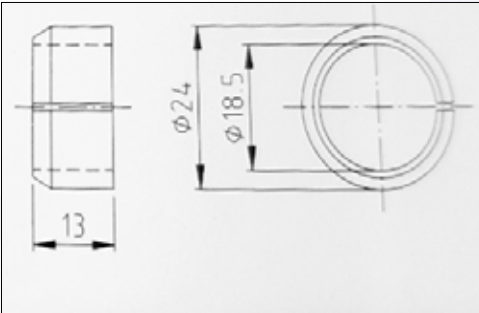

70 055191

Dimensioni / Dimensions	Kg	Pezzi / Pack

Adattatore 18/24 per fermacarico tonda
Adaptor for shoring poles



70 055176

Dimensioni / Dimensions	Kg	Pezzi / Pack
	0,29	1

Tampone di ricambio per cod. 70 055-175
Spare buffer for cod. 70 055-175



70 055122

Kg	Pezzi / Pack
2,35	1

Pinza in acciaio zincato per barra fermacarico
Galvanized steel clamp for block load bars



70 055121

Kg	Pezzi / Pack
0,01	1

Guarnizione in gomma per barra fermacarico
Rubber for block bars